

# BINDINGAGENTSSPREADER



**MS F-3 | MS R-5 | TS 1-8 | TS 2-12**

<http://amag.de>



# MOUNTED SPREADER

HIGHLIGHTS



- **No control panel needed - output controlled by hydraulic flow**
- **Exact spreading of binding agent**
- **Variable working width**
- **Dust curtain at the metering shaft**
- **Filling from BigBag possible**



Technical Data	MS F-3	MS R-5
Container	3m <sup>3</sup>	5m <sup>3</sup>
Filling interface	3"	
<b>Spreader Mechanism</b>		
Dosing system	Aluminium	
Output quantity <sup>1</sup>	5 - 60 kg/m <sup>2</sup>	
Spreading width	2500 mm	
Unladen weight	890 kg	1090 kg
Dimensions L x W x H	1.450 x 2.607 x 1.750m	1.650 x 2.610 x 1.900m
<b>Vehicle Requirements</b>		
Attachment	Linkage CAT2	Linkage CAT3
Hydraulics / Power	60 l/min / >80ps	

<sup>1</sup> Output quantity varies dependant on binding agent density and vehicle speed

Equipment	MS F-3	MS R-5
Fill level indicator		<input type="checkbox"/>
Infinitely variable spreading volume		<input checked="" type="checkbox"/>
Variable spreading width 1/3 — 2/3 split		<input type="checkbox"/>
Tool storage		<input checked="" type="checkbox"/>
Closed design with access hatch / filling from the top		<input checked="" type="checkbox"/>
Truck tarpaulin top		<input type="checkbox"/>
Filling interface Storz, alternative on request FOC		<input checked="" type="checkbox"/>
Filling interface 4" or 5"		<input type="checkbox"/>
Paintwork	RAL 9001 cremeweiss	
Custom paintwork		<input type="checkbox"/>

■ Standard □ Optional

MS F-3

DIMENSIONS

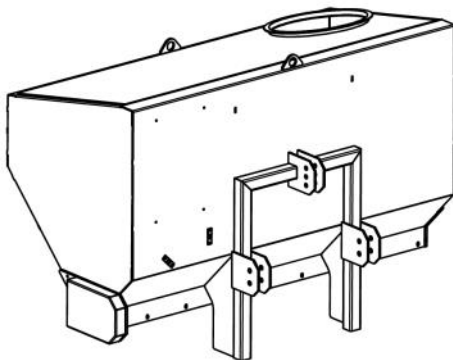
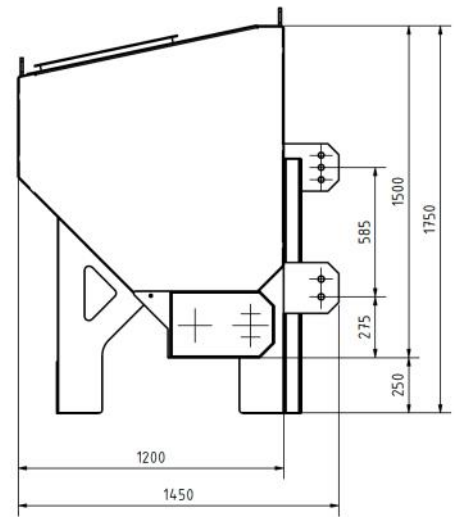
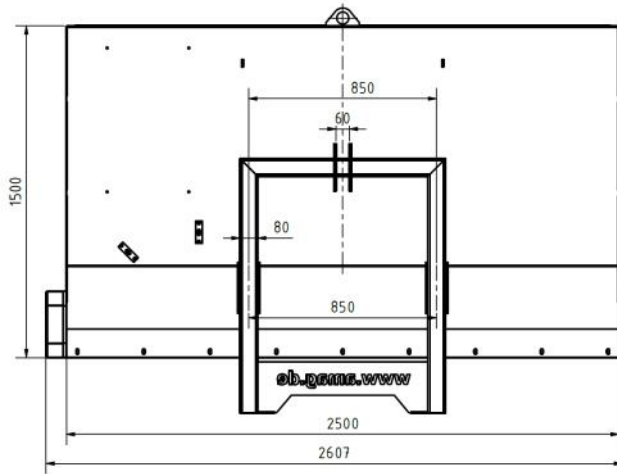

Front-mounted  
3m<sup>3</sup> capacity

MS R-5

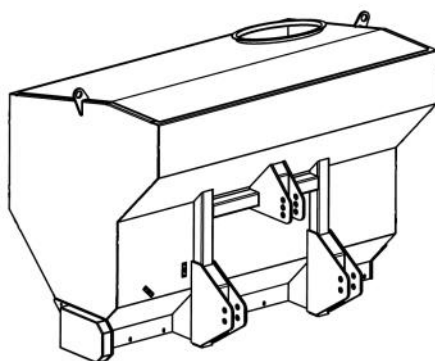
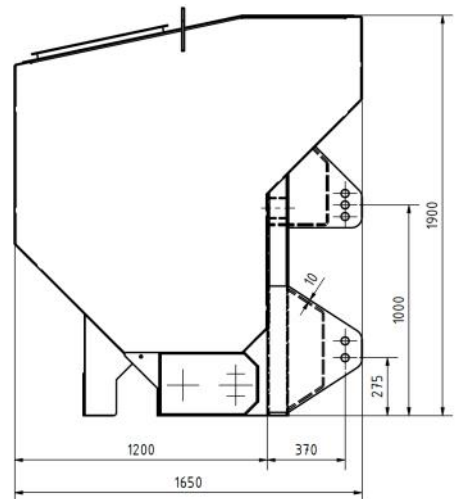
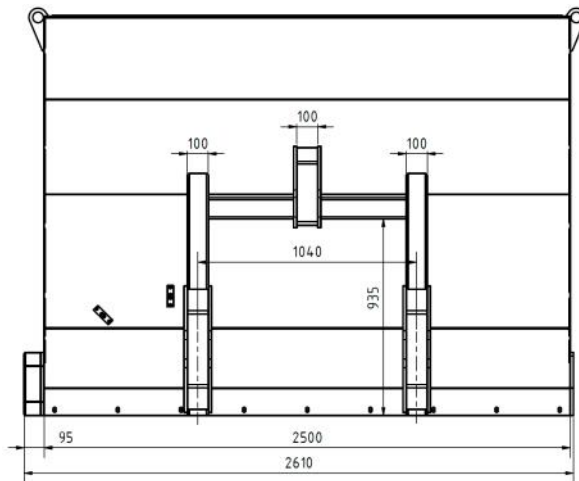

Rear-mounted  
5m<sup>3</sup> capacity

# TOWEDSPREADER

HIGHLIGHTS

- Fully hydraulic operation or in combination with PTO
- No control panel needed - output controlled by hydraulic flow
- Exact spreading of binding agent



- Variable working width left / right
- Dust curtain at the metering shaft
- Low maintenance screw conveyors
- Low centre of gravity — excellent stability



Technical Data	TS 1-8	TS 2-12
Container	8m <sup>3</sup>	12m <sup>3</sup>
Filling interface	3"	
Screw conveyors	4	
<b>Spreader Mechanism</b>		
Dosing system	Aluminium	
Output quantity <sup>1</sup>	5 - 60 kg/m <sup>2</sup>	
Spreading width	2500 mm	
Axles	1	2
Unladen weight		4.900 kg
Dimensions L x W x H	5.950 x 2.610 x 2.800m	6.685 x 2.610 x 2.719m
<b>Vehicle Requirements</b>		
Attachment	K-80	
Hydraulics	60 l/min	
Power take-off (PTO)	540/1000 rpm	

<sup>1</sup> Output quantity varies dependant on binding agent density and vehicle speed

Equipment	TS 1-8 / 2-12
Fill level indicator	■
Infinitely variable spreading volume	■
Twin dosing roller	□
Fully hydraulic operation	□
Variable spreading width 1/3 – 2/3 split	□
Tool storage	■
Ladder	■
Access hatch / Filling from the top	■
Wide tyres AS profile	■
Filling interface Storz, alternative on request FOC	■
Filling interface 4" or 5"	□
Paintwork	RAL 9001 cremeweiss
Custom paintwork	□
Alternative trailer coupling	□

■ Standard □ Optional

TS 2-12

DIMENSIONS

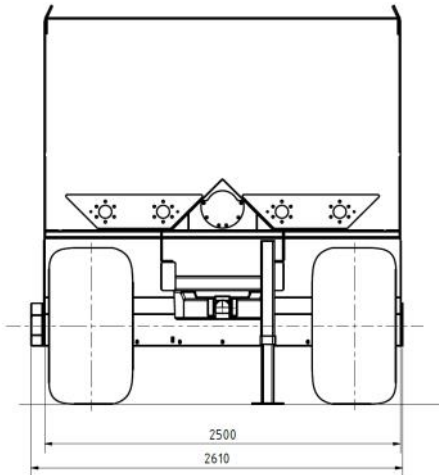

2 axles  
12m<sup>3</sup> capacity

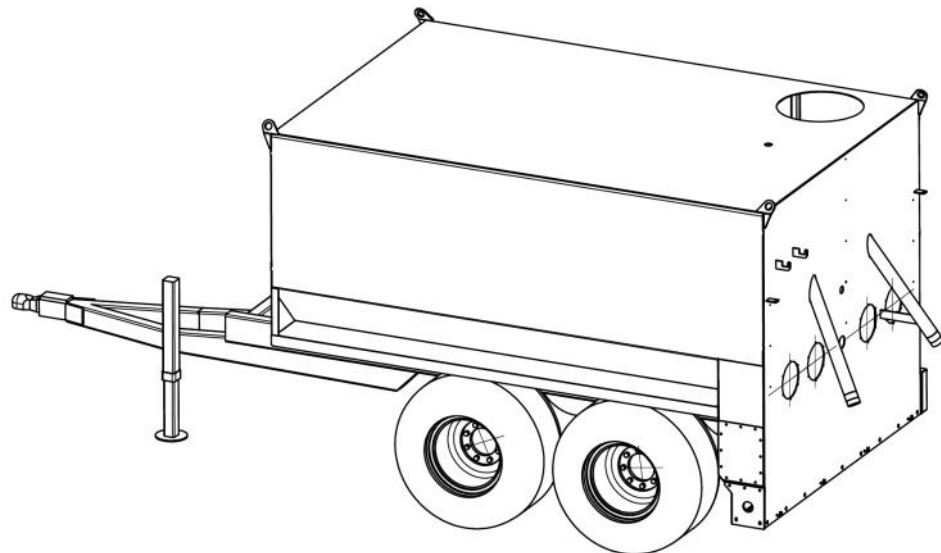
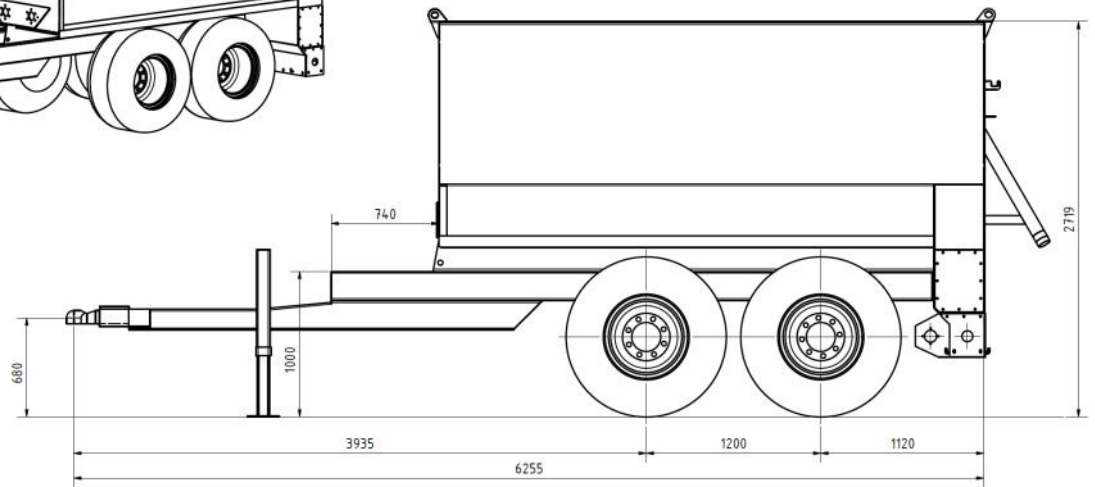
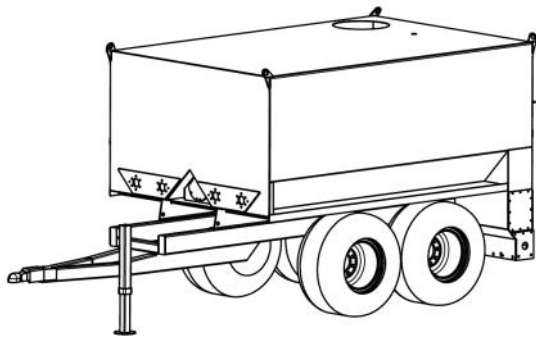

*Innovating since 1957*



**amag GmbH**

Hauptstrasse 100  
56745 Bell  
Germany

+49-2652-93936-0  
info@amag.de  
<http://amag.de>

